

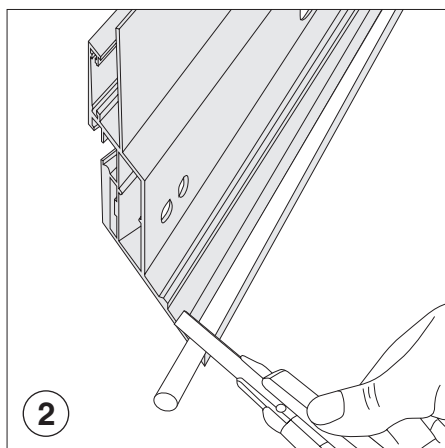

**Montaggio porta Luna battente con stipite esterno**  
***Mounting Luna wing door with external door jamb***

## Montaggio porta Luna battente con stipite esterno Mounting Luna wing door with external door jamb

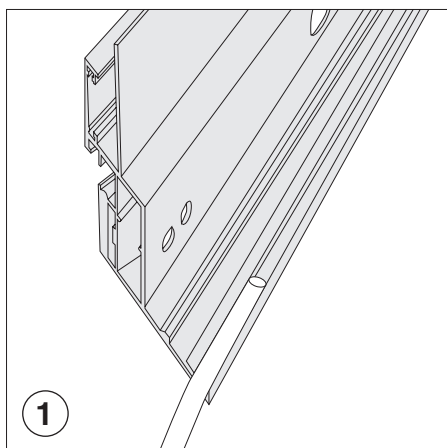

Prendere lo stipite orizzontale (traverso), e inserire la guarnizione nell'apposita fresata sul profilo (fig. 1); tagliarla in modo che sia della corretta lunghezza (fig. 2). Fare la stessa cosa per i profili verticali (montanti).  
Take the horizontal door jamb and insert the gasket into the proper milled of the profile (fig. 1) cut it in the correct length (fig. 2). Do the same for vertical profiles (uprights).

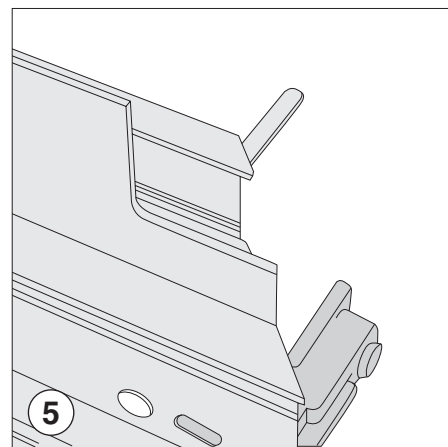
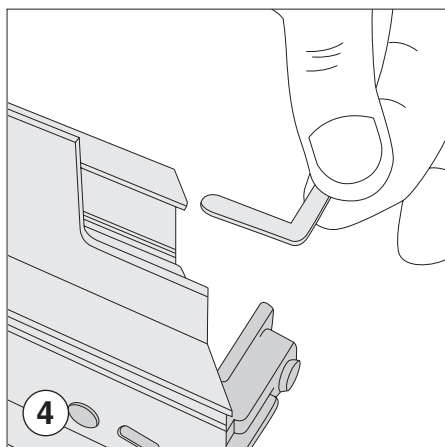
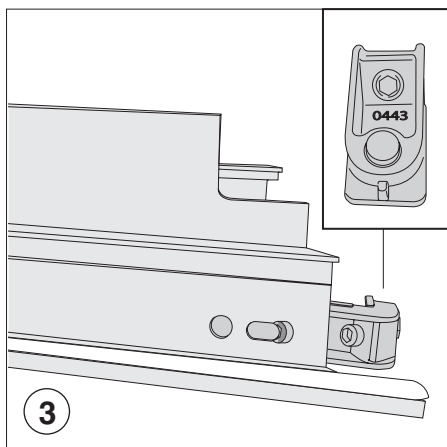

Inserire l'angolare di giunzione (cod. **0443**) nello stipite orizzontale, prestando attenzione che la testa della vite sia posizionata nel traverso (fig. 3); l'avvenuta installazione sarà confermata da un "click" che confermerà l'aggancio tra la pastiglia a scatto e il foro sul traverso. Inserire gli angolari di allineamento nelle apposite sedi (fig. 4-5).  
Insert the corner junction (item **0443**) into the horizontal door jamb, paying attention that screw head is positioned on the cross bar (fig. 3); the successful installation will be confirmed by a "click", it will ensure the hook between the snap pad and the hole on the cross bar. Insert the alignment corner junction into the proper seats (fig. 4-5).

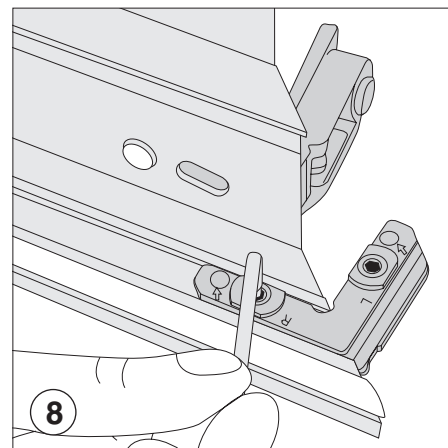
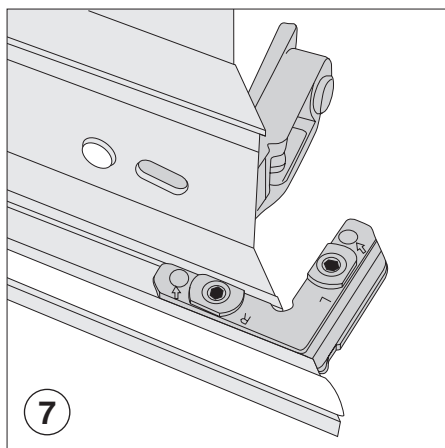
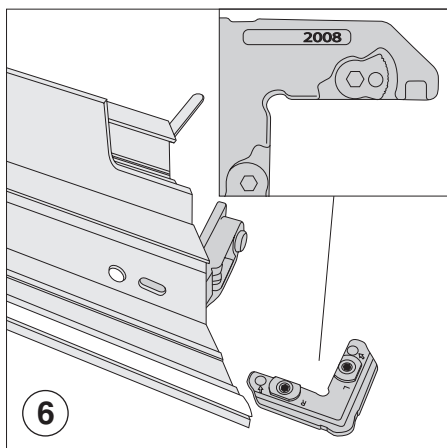

Inserire la squadretta codice **2008** nell'apposita sede (fig. 6-7), e bloccarlo ruotando l'eccentrico presente sulla squadretta stessa (fig. 8).  
Insert the bracket (item **2008**) into the proper seat (fig. 6-7) and block it rolling the pivot on it (fig. 8).

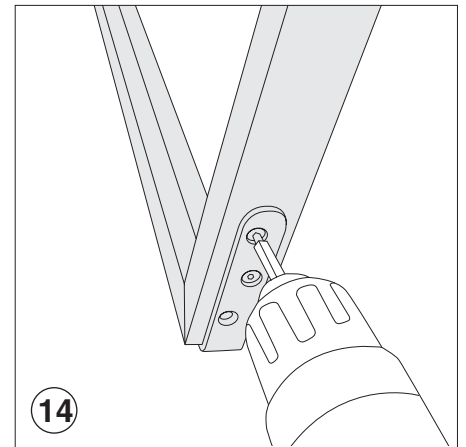
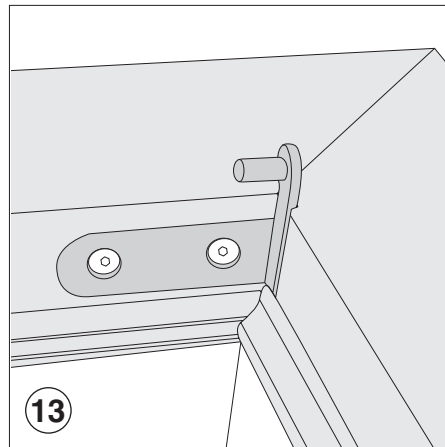
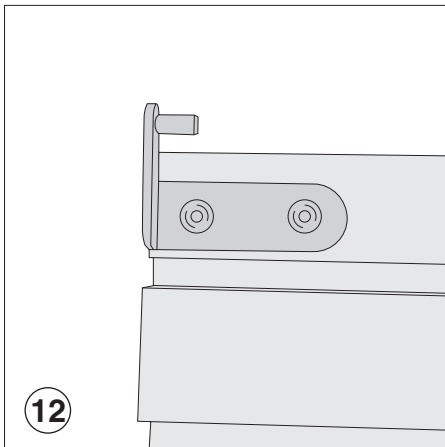
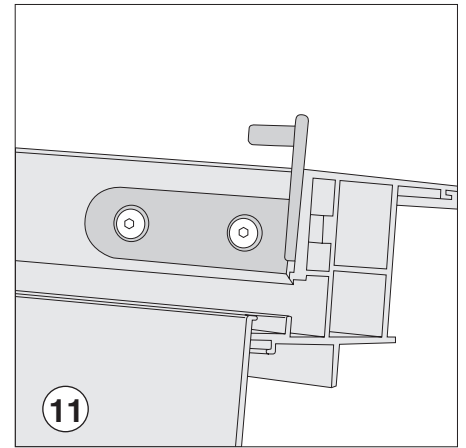
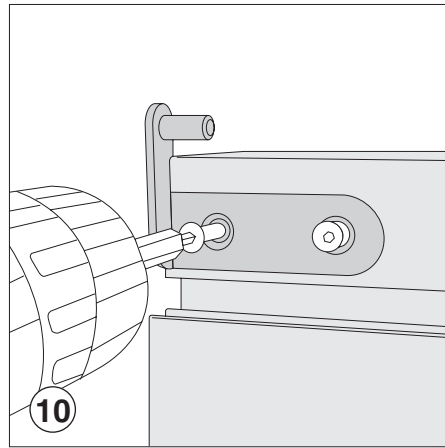
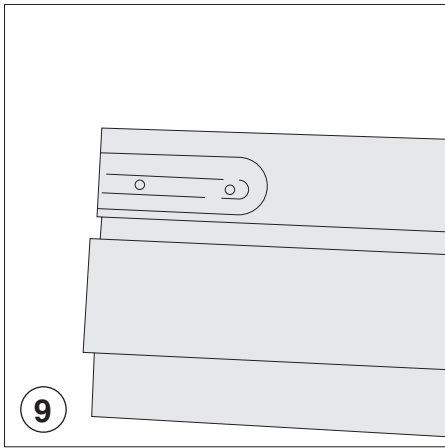

Alloggiare la staffa cerniera nell'apposita sede (fig. 9). Fissare la staffa cerniera superiore ed inferiore, utilizzando le viti in dotazione (fig. 10-11-12-13). Fissare la cerniera superiore al telaio, per mezzo dei fori esistenti (fig. 14).  
Settle the hinge stirrup on the proper seat (fig. 9). Fix the upper and lower hinge stirrup using supplied screws (fig. 10-11-12-13). Fix the upper hinge to the frame through existing holes (fig. 14).

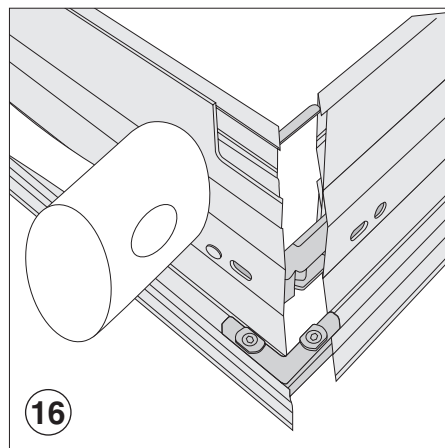
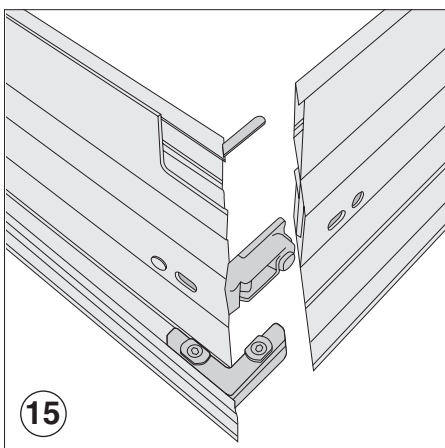

Accoppiare lo stipite verticale con quello orizzontale, facendo coincidere nelle apposite sedi tutti gli angolari precedentemente montati sul traverso; aiutarsi con un martello in plastica o gomma (fig. 15-16).  
Joint the vertical jamb to the horizontal one, making sure all corner brackets, previously mounted on the cross bars, are fitted in the proper seats. Help yourself by a plastic or rubber hammer (fig. 15-16).

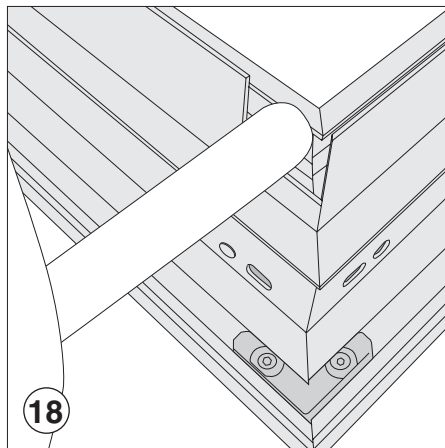
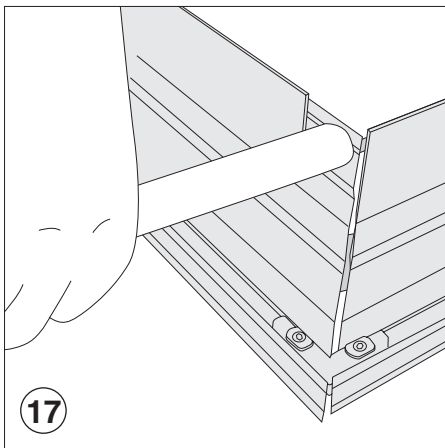

Per fare aderire correttamente l'angolo interno dello stipite, premere con un legno (o il manico del martello) le alette sullo stipite passando dallo scanso presente sul traverso dello stipite (fig. 17-18).  
*In order to adhere properly the jamb inner corner, push with a wooden strip or with the hammer handles the fins on the door jambs by passing on the avoidance through the jamb (fig. 17-18).*

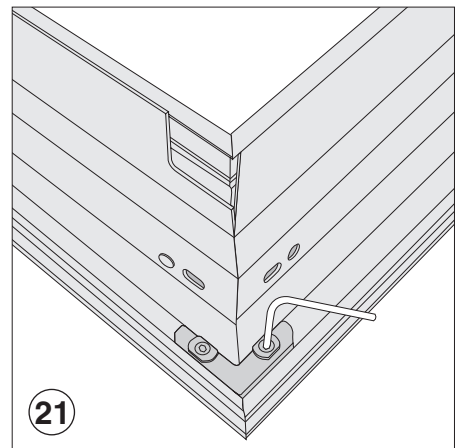
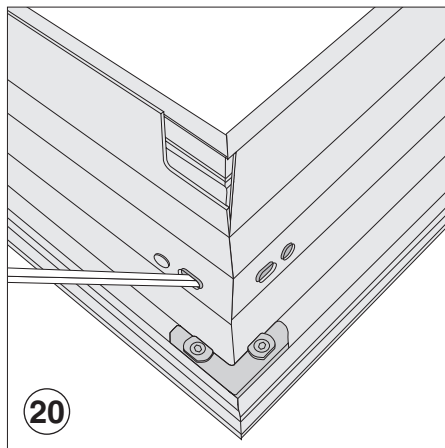
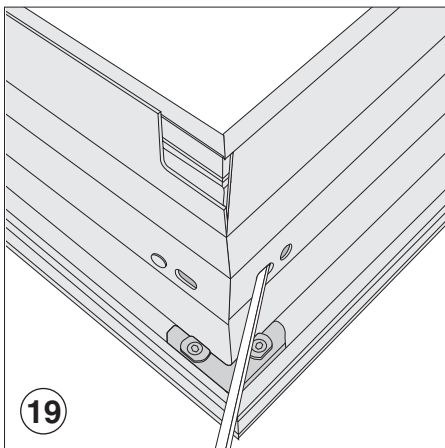

Il corretto accoppiamento tra orizzontale e verticale è confermato dal "click" udibile sulla pastiglia dell'angolare di giunzione. Avvenuto l'aggancio, serrare la squadretta agendo sulla vite dell'angolare di giunzione; per fare questo, raggiungere la vite tramite l'asola posta sul traverso (fig. 19-20). A questo punto, serrare anche la squadretta codice **0443** (fig. 21). Ripetere l'operazione anche per l'altro profilo verticale.

*The correct joint between horizontal and vertical one will be confirmed by a "click" audible on the corner junction pad. Achieved the hook, close the bracket acting on the screw corner junction. To do this, reach the screw through the hole on the cross bars (fig. 19-20). Now, close also the bracket item **0443** (fig. 21). Repeat the work for the vertical profile.*

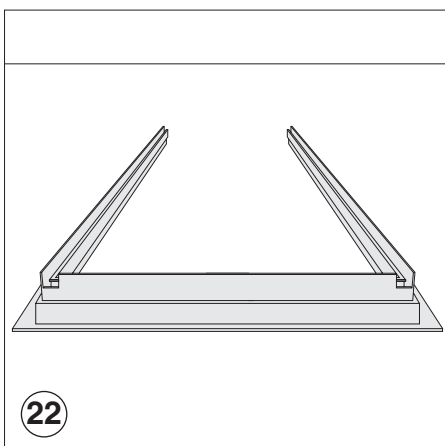

A questo punto, si avrà lo stipite montato (fig. 22).  
*At this step, you will have the door jambs mounted (fig. 22).*

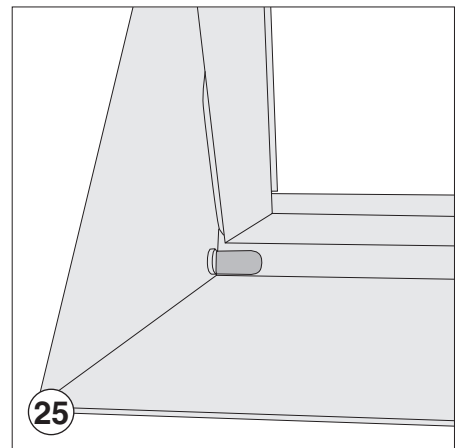
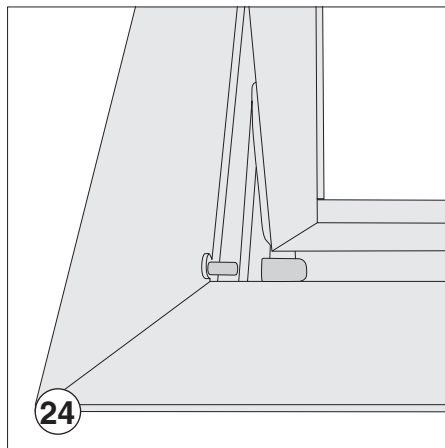
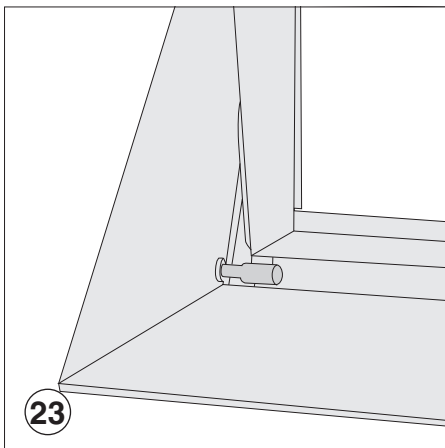

Dopo aver assemblato lo stipite, inserire la cerniera superiore montata sul telaio, a quella montata sullo stipite (fig. 23-24-25).  
*Once door jamb is assembled, insert the upper hinges installed on the frame, to the one installed on the door jamb (fig. 23-24-25).*

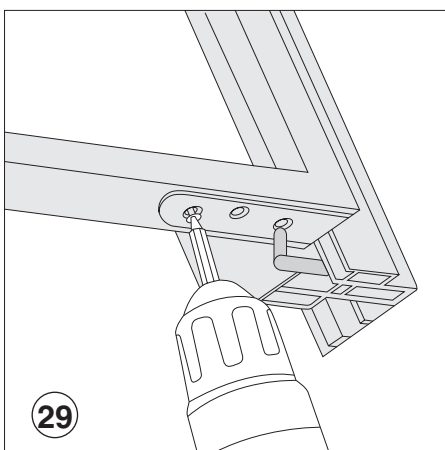
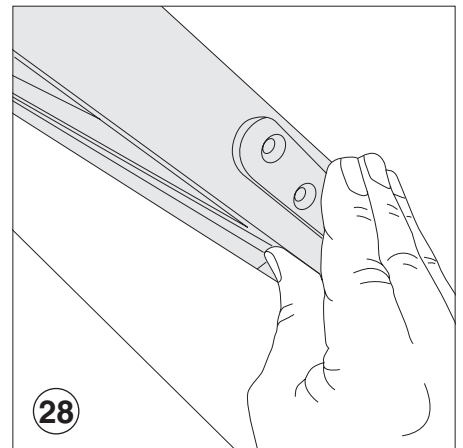
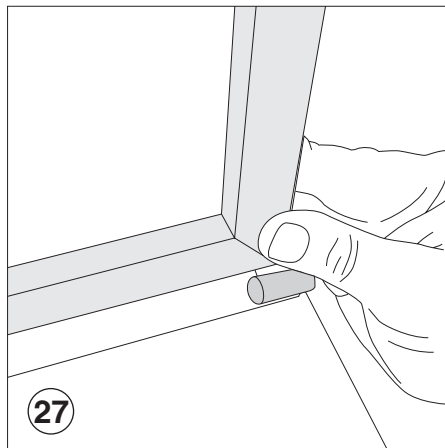
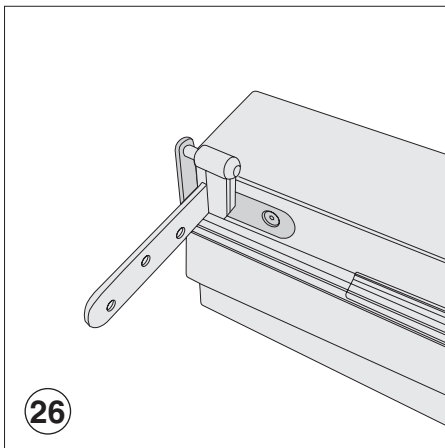

Inserire la cerniera inferiore (fig. 26) ed unirla al telaio con le apposite viti (fig. 27-28-29).  
*Insert the lower hinge (fig. 26) and joint it to the frame using proper screws (fig. 27-28-29).*

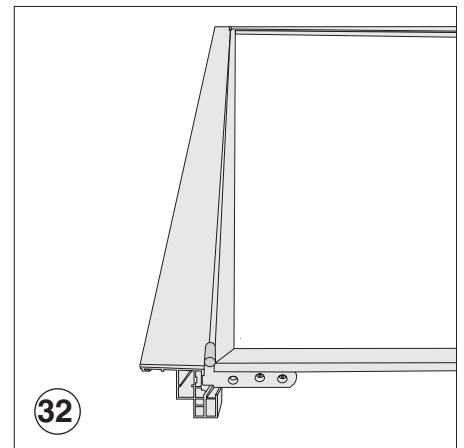
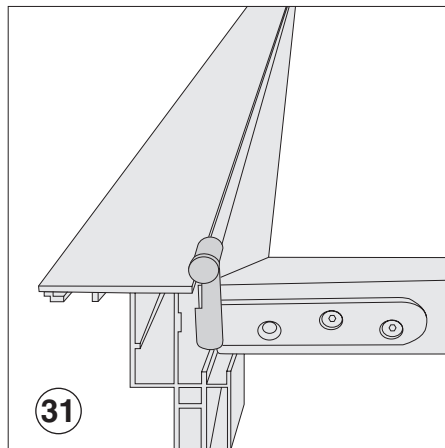
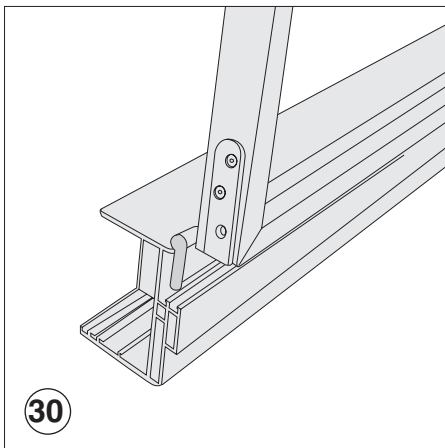

A questo punto, la porta è montata allo stipite. Passare all'installazione (fig. 30-31-32).  
 At this step, the door is installed to the door jamb. Go to the finally installation (fig. 30-31-32).

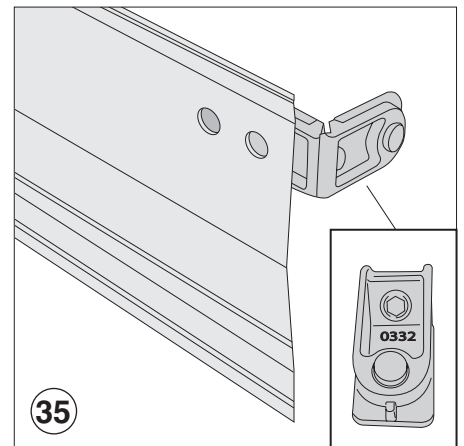
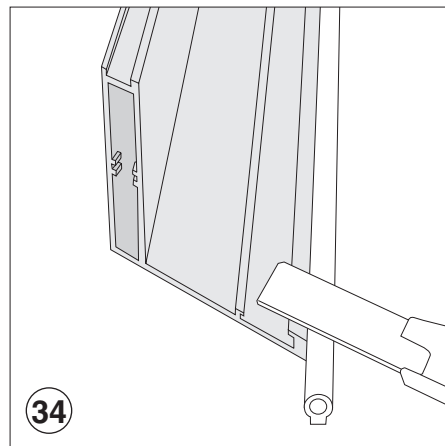
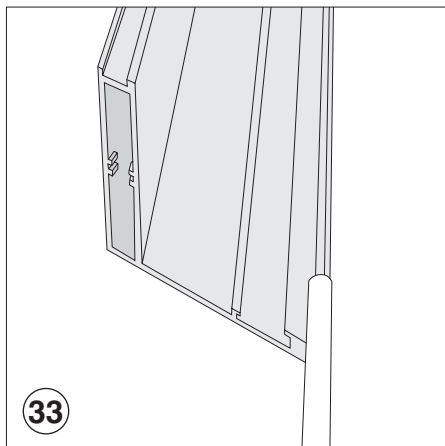

Procedere ora al montaggio del coprifilo: inserire la guarnizione nelle apposite sedi e tagliarla nella misura corretta (fig. 33-34);  
 inserire sul traverso orizzontale la squadretta codice **0332** facendo in modo che la pastiglia scatti nell'apposita sede (fig. 35).  
 You can proceed to the cover jamb mounting: insert the gasket in the proper seats and cut it in the right dimension (fig. 33-34).  
 Insert on the horizontal cross bar, the bracket (item **0332**) so that the pat snap in the proper seat (fig. 35).

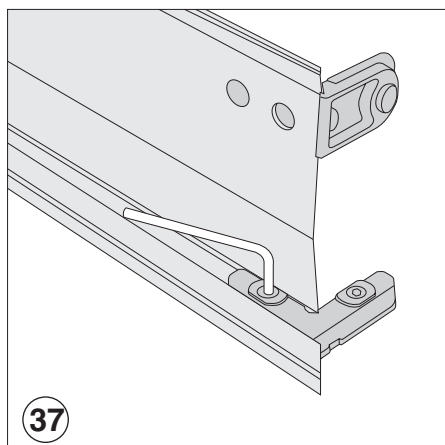
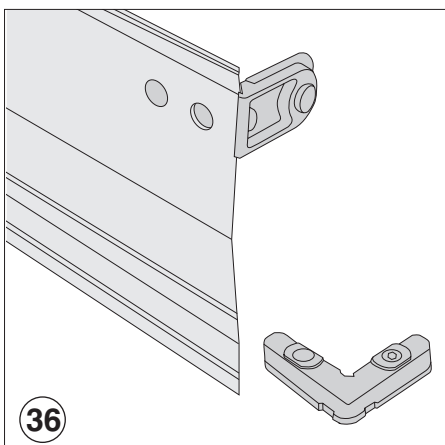

Inserire l'altra squadretta codice **2008** e bloccarla tramite l'apposito eccentrico (fig. 36-37).  
 Insert the second bracket (item **2008**) and block it through the proper tool (fig. 36-37).

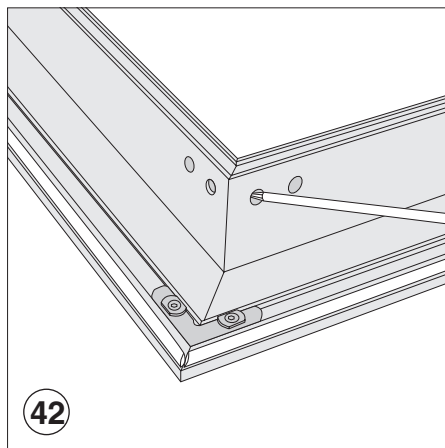
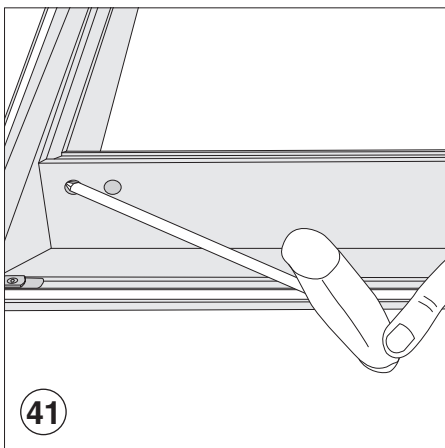
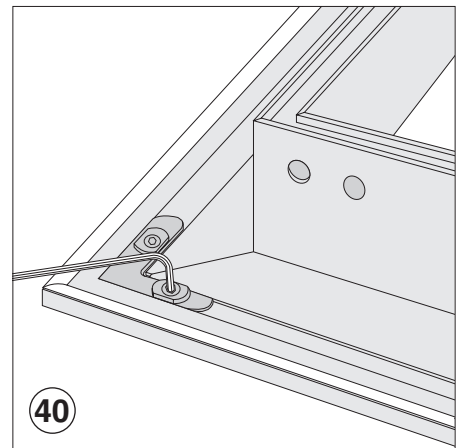
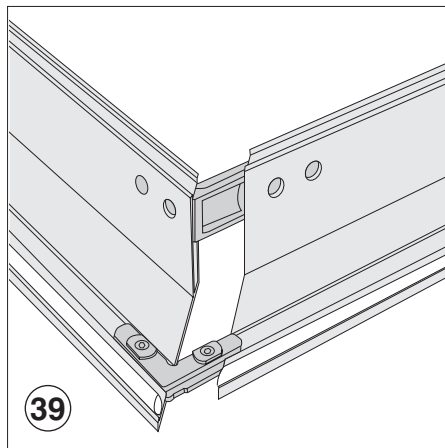
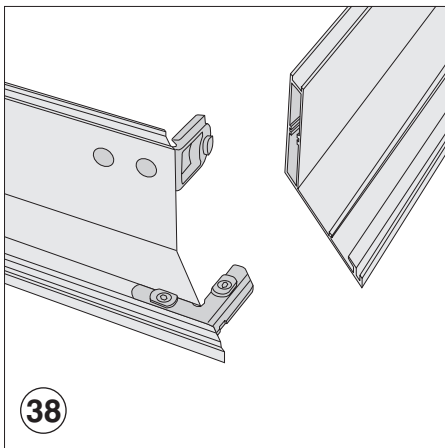

A questo punto, unire i due verticali con il profilo orizzontale; fare prima scattare le pastiglie nelle apposite sedi, quindi serrare gli angolari (fig. 38-39-40-41-42). A questo punto, si ha il coprifilo montato.  
*Joint 2 vertical profiles with the horizontal profile; make sure pads has snapped in the proper seat, than close the corners. (fig. 38-39-40-41-42). The profile is now mounted.*

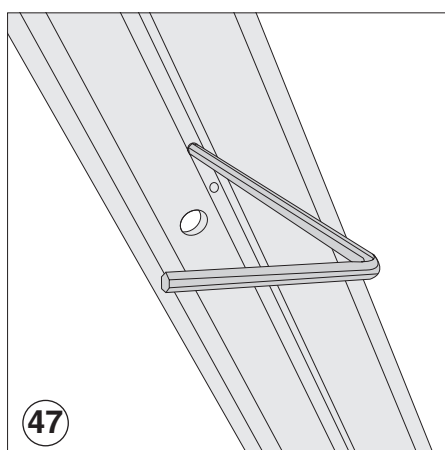
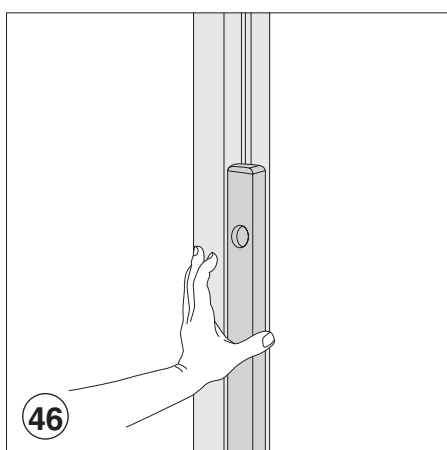
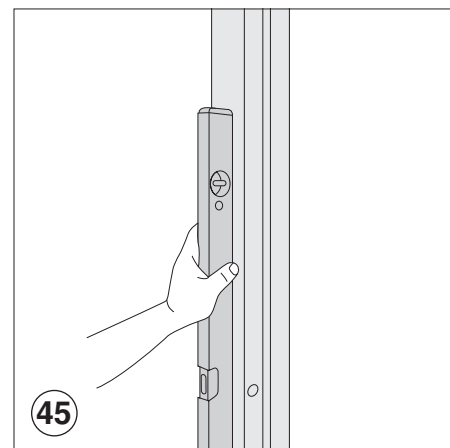
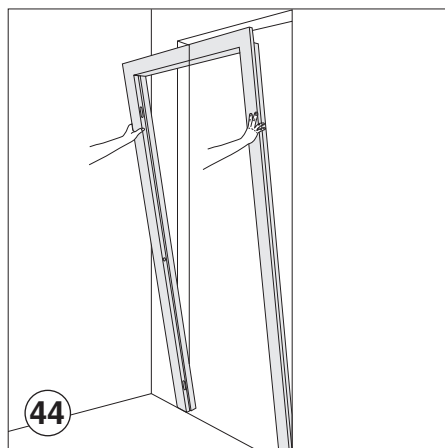
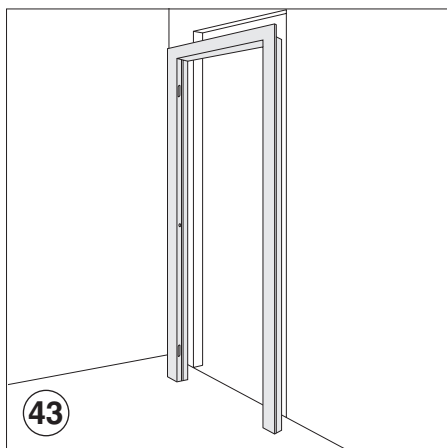

Inserire lo stipite con la porta montata (fig. 43-44-45) nel vano muro, e prestare attenzione alla corretta messa in bolla (fig. 46). Correggere il fuori piombo con gli appositi distanziali in dotazione; per agire su questi ultimi, servirsi della chiave esagonale (fig. 47) in dotazione.

*Insert the door-jamb at door installed (fig. 43-44-45) in the wall compartment, paying attention to the correct levelling (fig. 46). Adjust the eventually differences using the supplied spacer. To act on them use the supplied hexagonal key (fig. 47).*

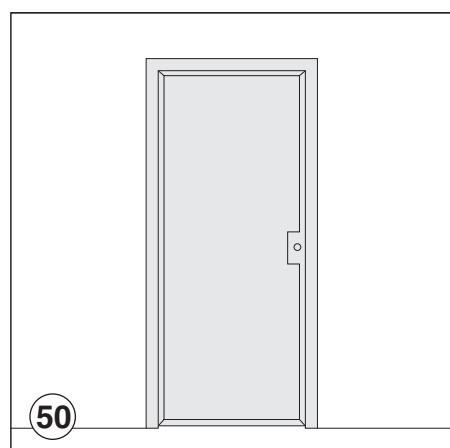
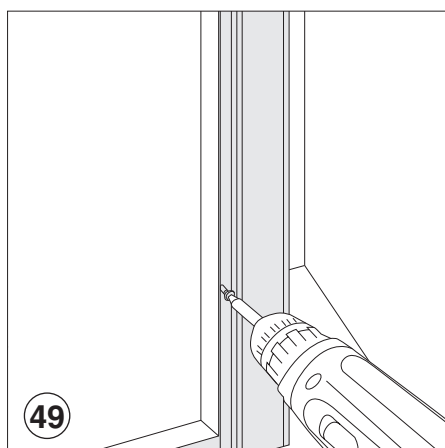
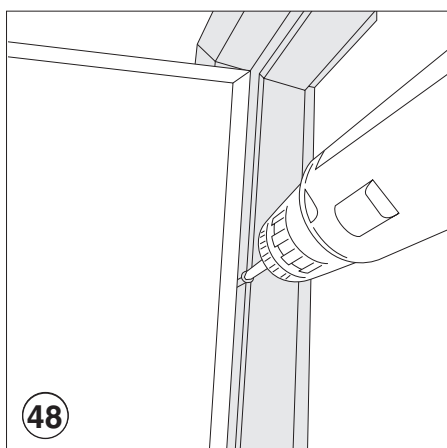

Una volta regolato, fissarlo in posizione mediante le apposite viti auto foranti (fig. 48-49). A questo punto la porta è montata.

*Once adjusted, fix it in the position through the proper self drilling screws (fig. 48-49). Now, your door is mounted.*



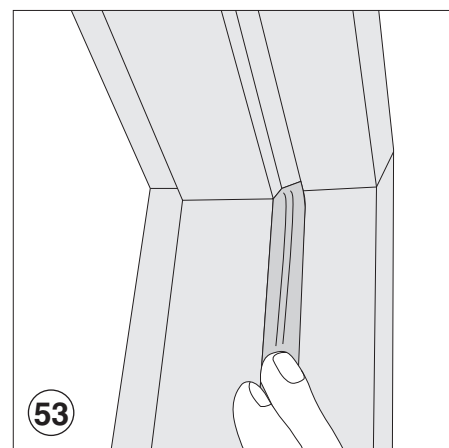
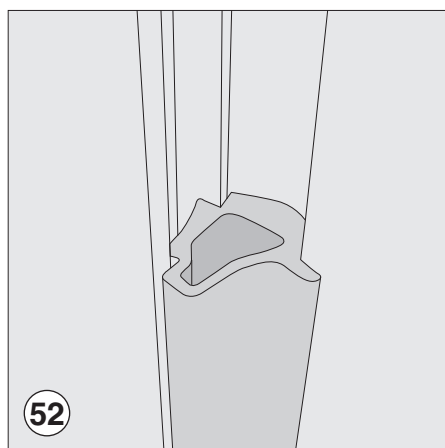
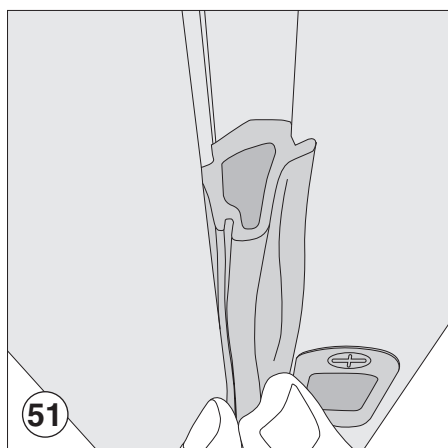

Procedere con l'inserimento della speciale gomma in silicone di battuta facendola "scattare" nelle apposite sedi (fig. 51-52-53) lungo tutto il perimetro dello stipite.  
*Insert the special silicon rubber side beat, along of the jamb perimeter until it locks in its seat (fig. 51-52-53).*

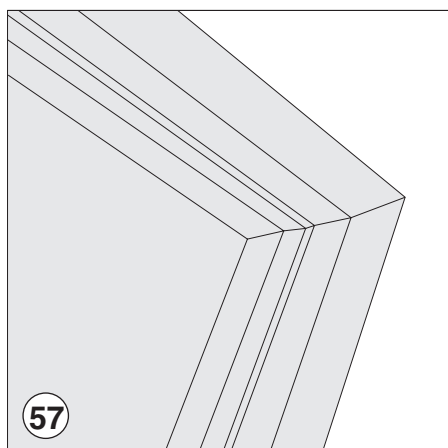
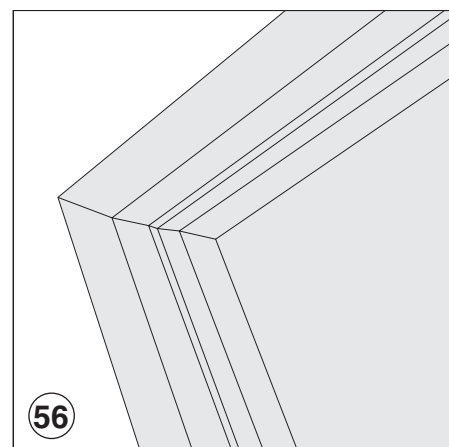
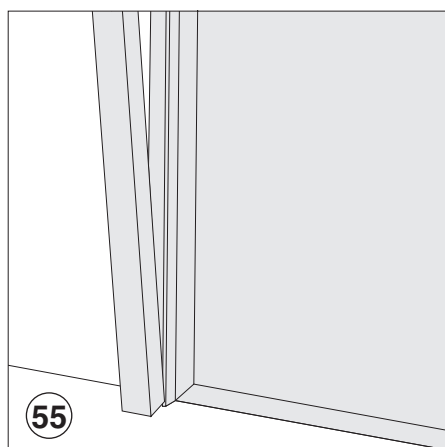
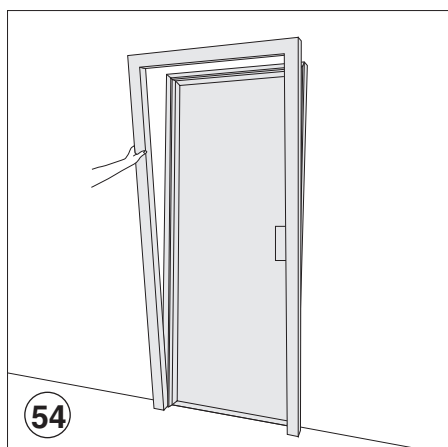

Montare il coprifilo telescopico inserendolo nello stipite (fig. 54-55) e facendolo aderire alla parete bloccandolo con del silicone (fig. 56-57).  
*Install the telescopic cover jamb inserting it in the jamb (fig. 54-55) and fixing it to the wall using silicon (fig. 56-57).*







Porte e sistemi

Italia 20038, Seregno (Milano) via Cassina Savina, 49

T +39 0362 238620 F +39 0362 327860 [www.resitalia.it](http://www.resitalia.it) e-mail: [info@resitalia.it](mailto:info@resitalia.it)